

640 Series Sprinkler Component Assembly Instructions

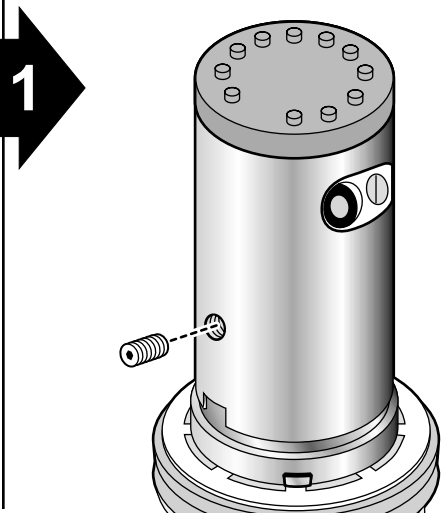

1 Thread nozzle turret onto riser assembly and secure with 1/16" hex set screw.

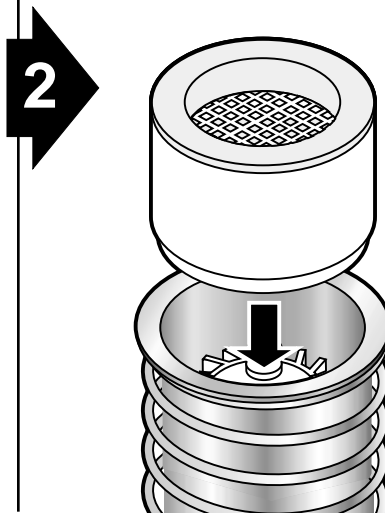

2 Press stator assembly into bottom of riser assembly.

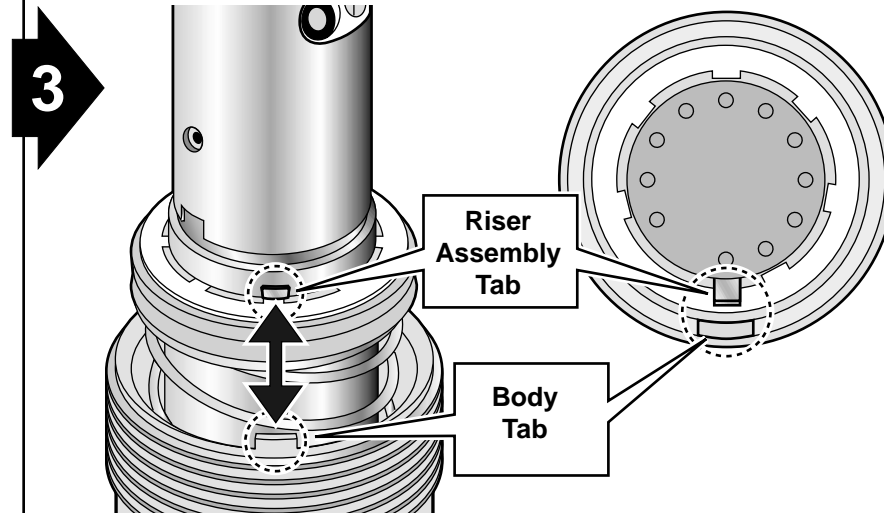

3 Insert riser assembly into body. Align riser assembly tab with body tab as shown.

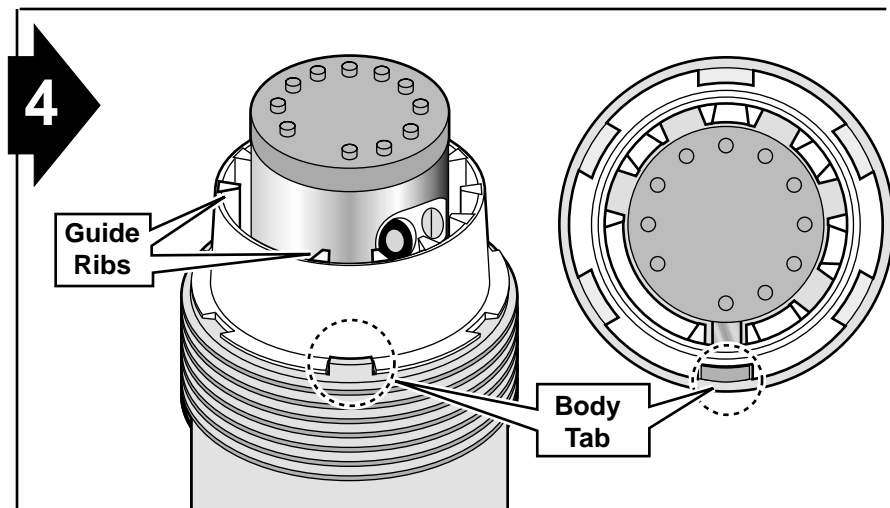

4 Insert nozzle retainer into body. Note spacing of guide ribs and align with riser assembly tab and body tab as shown.

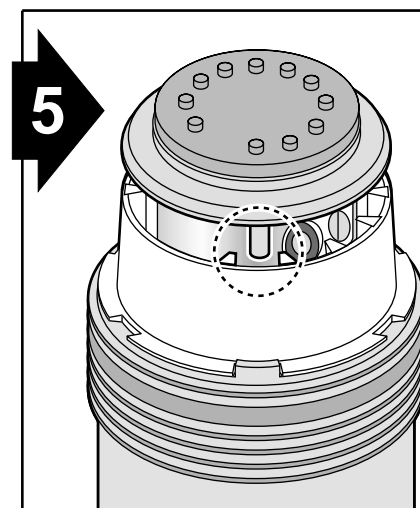

5 Install nozzle seal with boss inserted between guide ribs.

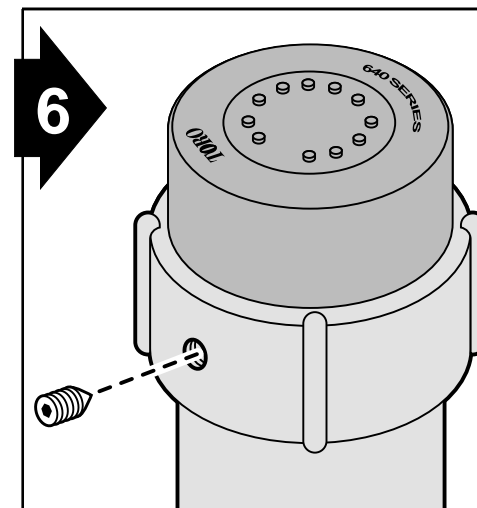

6 Install cap and secure with 1/8" hex set screw.