

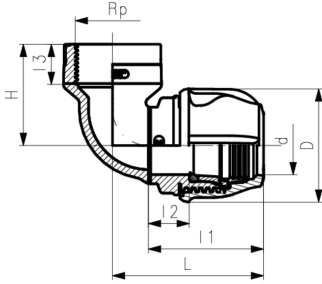

90° Elbow with threaded female off take

- with stainless steel reinforcement ring (AISI430)
- gasket: NBR quality for drinkable water
- installation without disassembling
- suitable for PE and PEX pipes
- water PN16
- material: PP
- female thread: ISO 7 (parallel)
- colour: blue-black



| d | Rp | PN | Code | SP | GP | Weight | D | L | l1 | l2 | l3 | H |
|------|--------|-------|--------------------|----|-----|--------|------|------|------|------|------|------|
| (mm) | (inch) | (bar) | | | | (kg) | (mm) | (mm) | (mm) | (mm) | (mm) | (mm) |
| 16 | ½ | 16 | 158 400 360 | 10 | 50 | 0.061 | 45 | 67 | 54 | 19 | 15 | 40 |
| 20 | ½ | 16 | 158 400 022 | 10 | 180 | 0.046 | 45 | 67 | 54 | 19 | 15 | 40 |
| 20 | ¾ | 16 | 158 400 023 | 10 | 180 | 0.053 | 45 | 67 | 54 | 19 | 16 | 40 |
| 25 | ½ | 16 | 158 400 024 | 10 | 150 | 0.067 | 53 | 75 | 59 | 21 | 15 | 40 |
| 25 | ¾ | 16 | 158 400 025 | 10 | 150 | 0.071 | 53 | 75 | 59 | 21 | 16 | 44 |
| 25 | 1 | 16 | 158 400 026 | 10 | 120 | 0.081 | 53 | 75 | 59 | 21 | 16 | 44 |
| 32 | ½ | 16 | 158 400 027 | 10 | 110 | 0.099 | 64 | 87 | 66 | 23 | 15 | 43 |
| 32 | ¾ | 16 | 158 400 028 | 10 | 110 | 0.110 | 64 | 87 | 66 | 23 | 16 | 46 |
| 32 | 1 | 16 | 158 400 029 | 10 | 100 | 0.121 | 64 | 87 | 66 | 23 | 20 | 54 |
| 32 | 1 ¼ | 16 | 158 400 030 | 10 | 90 | 0.131 | 64 | 87 | 66 | 23 | 22 | 57 |
| 40 | ¾ | 16 | 158 400 031 | 70 | 0 | 0.159 | 75 | 102 | 76 | 26 | 16 | 49 |
| 40 | 1 | 16 | 158 400 032 | 70 | 0 | 0.176 | 75 | 102 | 76 | 26 | 20 | 57 |
| 40 | 1 ¼ | 16 | 158 400 033 | 70 | 0 | 0.191 | 75 | 102 | 76 | 26 | 22 | 62 |
| 40 | 1 ½ | 16 | 158 400 034 | 50 | 0 | 0.200 | 75 | 102 | 76 | 26 | 22 | 63 |
| 50 | 1 | 16 | 158 400 035 | 30 | 0 | 0.303 | 97 | 119 | 88 | 30 | 20 | 61 |
| 50 | 1 ¼ | 16 | 158 400 036 | 30 | 0 | 0.324 | 97 | 119 | 88 | 30 | 22 | 66 |
| 50 | 1 ½ | 16 | 158 400 037 | 30 | 0 | 0.335 | 97 | 119 | 88 | 30 | 22 | 70 |
| 50 | 2 | 16 | 158 400 038 | 30 | 0 | 0.371 | 97 | 119 | 88 | 30 | 26 | 75 |
| 63 | 1 ¼ | 16 | 158 400 039 | 15 | 0 | 0.537 | 114 | 144 | 104 | 35 | 22 | 73 |
| 63 | 1 ½ | 16 | 158 400 040 | 15 | 0 | 0.561 | 114 | 144 | 104 | 35 | 22 | 76 |
| 63 | 2 | 16 | 158 400 041 | 15 | 0 | 0.604 | 114 | 144 | 104 | 35 | 26 | 83 |
| 75 | 2 | 16 | 158 400 042 | 12 | 0 | 0.949 | 135 | 180 | 133 | 41 | 26 | 91 |
| 75 | 2 ½ | 16 | 158 400 043 | 12 | 0 | 1.003 | 135 | 180 | 133 | 41 | 31 | 101 |
| 75 | 3 | 10 | 158 400 044 | 10 | 0 | 1.112 | 135 | 180 | 133 | 41 | 34 | 108 |
| 90 | 3 | 10 | 158 400 045 | 6 | 0 | 1.615 | 161 | 207 | 150 | 44 | 34 | 116 |
| 110 | 4 | 10 | 158 400 046 | 3 | 0 | 2.474 | 185 | 242 | 175 | 53 | 40 | 135 |

The technical data are not binding. They neither constitute expressly warranted characteristics nor guaranteed properties nor a guaranteed durability. They are subject to modification. Our General Terms of Sale apply.

Georg Fischer Piping Systems Ltd, Postfach, CH-8201 Schaffhausen/Switzerland

Phone +41 -(0)52-631 1111

e-mail: info.ps@georgfischer.com

Internet: <http://www.gfps.com>